

scJohnson
PROFESSIONAL
A family company®

PRODUCT
GUIDE

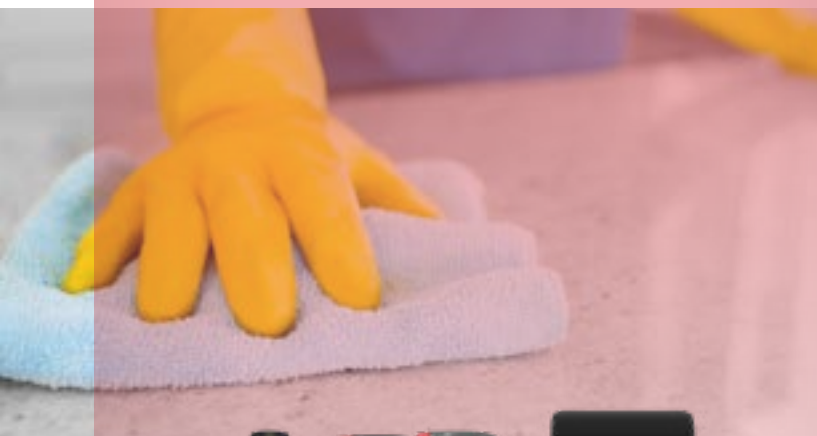

SKIN CARE • FLOOR CARE • SURFACE CARE • FABRIC & AIR CARE • PEST CONTROL • STORAGE SOLUTIONS • TECHNOLOGY SOLUTIONS

RETHINKING THE PROFESSIONAL EXPERIENCE

About SC Johnson Professional

SC Johnson Professional® is a part of SC Johnson®, a global, purpose-led company and industry-leading manufacturer of household consumer brands such as Windex®, Mr Muscle® and Mrs. Meyer's Clean Day®.

With operations beginning in the 1930s, SC Johnson Professional® provides expert skin care, cleaning and hygiene solutions for industrial, institutional and healthcare users. This incorporates our range of specialist occupational skin care products along with well-known SC Johnson® brands and innovative professional cleaning and hygiene products.

The SC Johnson Professional® purpose is to bring innovative, quality products and services to professional markets with outstanding performance that create efficiencies, reduce inventories, simplify training and provide a positive user experience. This is built on a deep understanding of customer needs and a vision for 'rethinking the professional experience' with the user in mind.

TABLE OF CONTENTS:

SKINCARE	4-25
FLOORCARE	26-33
SURFACE CARE	34-43
FABRIC & AIR CARE	44-45
SPECIALTY OFFERINGS.....	46-49
PEST CONTROL.....	47
STORAGE.....	48
TECHNOLOGY SOLUTIONS.....	49

ELEVATING EXPECTATIONS FOR CUSTOMERS & USERS





SKIN CARE

PROTECT • CLEANSE • SANITIZE • RESTORE

THE SC JOHNSON PROFESSIONAL RANGE OFFERS SPECIALIZED CLEANING OPTIONS FROM LIGHT TO HEAVY REQUIREMENTS, HAND DISINFECTION FOR HYGIENE SENSITIVE ENVIRONMENTS AS WELL AS RESTORATION WITH WORLD-RENOWNED SKIN CARE CREAMS.

SC JOHNSON PROFESSIONAL PRODUCT BRANDS



PROTECT

Travabon®

Skin defense cream for oil-based and adherent contaminants

Stokoderm®

Skin defense creams for water-based contaminants, multiple contaminant type or specific work environments



CLEANSE

Refresh™

Washroom foam soaps and shower products

Antimicrobial

Washroom antibacterial foam soap under the Refresh™ brand ideal for food-industry specific antimicrobial foam soap

Estesol®

Light duty hand, hair and body cleaners

Solopol®

Solvent-free heavy duty hand cleaners

Kresto®

Solvent-based super heavy and specialist hand cleaners and wipes



SANITIZE

InstantFOAM™ Complete

Alcohol-based foam hand sanitizer for use without water

InstantFOAM™ Non-Alcohol

Dye and fragrance free, non-alcohol-based foam hand sanitizer for use without water



RESTORE

Stokolan®

After-work skin moisturizing and conditioning cream

SBS® 40

After-work skin conditioning cream

CLEANSE CATEGORY KEY:

	SCJP Brand	SCJP Cleanse Rating
■ WASHROOM	Refresh™	1
■ ANTIMICROBIAL	Refresh™ / AgroBac™	1
■ LIGHT DUTY	Estesol®	2
■ MEDIUM HEAVY	Solopol®	3
■ HEAVY	Solopol® / Kresto®	4
■ SUPER-HEAVY	Kresto®	5
■ ULTRA	Kresto®	5

CLICK HERE
TO LEARN MORE!

To find the correct product for your needs, click above for our product selector.

UNIVERSAL APPLICATION



Stokoderm® Protect

General Skin Defense Cream Oil | Grease | Lubricants | Detergents



WHERE TO USE:

Light to moderate exposure to oil-based and water-based substances where gloves may be in use.

- General purpose skin defense cream to help defend the skin against light to moderate exposure to water and non-water-based workplace contaminants
- Perfume-free
- Suitable for food facilities

Water & Oil-Based Substances

CODE	CASE QTY	SIZE
UPW100ML	12	100ml Tube
UPWIL	6	1 Liter Cartridge
PROILDS	15	1 Liter Dispenser

SPECIALIST APPLICATION



Travabon® Classic

Oil, Grease and Adherent Defense Cream Oil | Grease | Adhesive Based Substances



WHERE TO USE:

Water-insoluble substances such as solvents, metal-working oils and mechanical soiling; where it is not practical or feasible to wear gloves.

- Specialist dual action pre-work cream to defend the skin against heavy levels of oil-based and adherent substances
- Contains a special soil-suspending emulsifier to make skin easier to clean
- Scientifically proven to provide defense against the irritating effects of oil/solvent-based substances

Oil-Based & Adherent Substances

CODE	CASE QTY	SIZE
TVC100ML	12	100ml Tube



Stokoderm® Aqua PURE

Water Defense Cream Water | Detergents | Cleaning Agents



WHERE TO USE:

Prolonged exposure to water and water-based contaminants and frequent hand washing requirements; can be used with gloves or PPE.

- Specialist wet-work cream to defend against prolonged or frequent contact with water or water-based substances
- A unique emulsion structure allows active ingredients to penetrate deeply in to the skin to support its natural barrier function
- Suitable for food facilities

Water-Based Substances

CODE	CASE QTY	SIZE
SAQ100ML	12	100ml Tube
SAQIL	6	1 Liter Cartridge
PROILDS	15	1 Liter Dispenser



Stokoderm® Sunscreen PURE

Broad Spectrum SPF 30 Sunscreen for Professional Use
UVA | UVB | SPF30 | UVC



WHERE TO USE:

Outdoor workers exposed to UVA & UVB sun rays and workers exposed to UVC rays created during some industrial processes; suitable for use by outdoor electricians wearing electrical insulating gloves.

- Broad spectrum SPF 30 sunscreen for professional use against UVA and UVB rays
- Water-resistant, perfume-free and dye-free
- Made without Oxybenzone and Octinoxate - complies with Hawaii Act No. 104 (2018) and Key West Sunscreen Ordinance, banning sunscreens that contain Oxybenzone and Octinoxate

Sunscreen

CODE	CASE QTY	SIZE
SUN100ML	12	100ml Tube
SUNIL	6	1 Liter Cartridge
SUNILDS	15	1 Liter Dispenser

Recommended Dispenser



Pre-Work Dispensers

CODE	DISPENSER NAME	COLOR	CASE QTY	TO USE WITH
PROILDS	SCJ Professional Pre-work Cream	White	15	UPWIL, SAQIL
SUNILDS	SCJ Professional Sunscreen	White	15	SUNIL

¹ECARF Seal of Quality - This product meets the European Centre for Allergy Research Foundation (ECARF) criteria for skin tolerability. For more information go to <http://Ecarf-siegel.org/en/about-seal>

CLASSIC FOAMS



Refresh™ Clear FOAM

Perfume-free & Dye-free Gentle Foam Handwash

FOAM

WHERE TO USE:

Washroom areas in offices, public facilities, healthcare settings and food handling environments.

- Perfume-free and dye-free: Designed for people who are sensitive to perfumes and dyes and who prefer products which do not have these added
- Skin Hypoallergenic: Dermatologist tested to verify and confirm this product has very low allergenic potential and is designed for sensitive skin

CODE	CASE QTY	SIZE
CLR1L	6	1 Liter Cartridge
WRM1LDS	15	1 Liter Dispenser
CLR120TF	3	1.2 Liter for TF Ultra
CLR16LC	4	1.6 Liter for CTF Ultra
CLR2LT	4	2 Liter Cartridge
WRM2LDP	8	2 Liter Dispenser

See page 10 for additional compatible dispensers

Refresh™ Azure FOAM

Signature Fragrance Fresh Apple Foam Handwash

FOAM



WHERE TO USE:

Washroom areas in offices and public facilities.

- A Fresh Apple fragrance with caring, pleasantly fresh and clean notes to elevate the restroom experience for every day use. Proven to have broad appeal amongst washroom users
- Mild Formulation: Dermatologist tested to verify and confirm this product does not elicit dermal irritation

CODE	CASE QTY	SIZE
AZU10FL	16	10 fl oz Pump Bottle
AZU1L	6	1 Liter Cartridge
WRM1LDS	15	1 Liter Dispenser
AZU120TF	3	1.2 Liter for TF Ultra
AZU16LC	4	1.6 Liter for CTF Ultra
AZU2LT	4	2 Liter Cartridge
WRM2LDP	8	2 Liter Dispenser
51105	4	1 Gallon Bottle

See page 10 for additional compatible dispensers

Refresh™ Rose FOAM

Signature Fragrance Enchanted Rose Foam Handwash

FOAM



WHERE TO USE:

Washroom areas in offices and public facilities.

- An Enchanted Rose fragrance with caring, pleasantly fresh and clean notes to elevate the restroom experience for every day use. Proven to have broad appeal amongst washroom users
- Mild Formulation: Dermatologist tested to verify and confirm this product does not elicit dermal irritation

CODE	CASE QTY	SIZE
RFW1L	6	1 Liter Cartridge
WRM1LDS	15	1 Liter Dispenser
RFW120TF	3	1.2 Liter for TF Ultra
RFW2LT	4	2 Liter Cartridge
WRM2LDP	8	2 Liter Dispenser

See page 10 for additional compatible dispensers



Refresh™ Energie FOAM

Premium Foam Hand Wash - Fragranced

FOAM



WHERE TO USE:

Washroom areas in offices and public facilities.

- Citrus and spice fragrance designed to instill a sense of "energy" to your facility
- Contains glycerin, a skin moisturizer to help prevent drying and leave the skin feeling smooth after use
- Rich foam soap dispenses on the hands with quick and easy rinsing

CODE	CASE QTY	SIZE
ENGL	6	1 Liter Cartridge

See page 10 for additional compatible dispensers

HAIR & BODY

Refresh™ Luxury 3-in-1 Hair & Body

Luxurious 3-in-1 Body Wash, Shampoo and Conditioner

LOTION



WHERE TO USE:

Any workplace, leisure or hospitality shower facility.

- High quality, creamy lotion produces rich, luxurious lather
- Leaves the hair and skin feeling smooth and conditioned after use
- Pleasant, powdery floral fragrance

CODE	CASE QTY	SIZE
CMWIL	6	1 Liter Cartridge
SHW1LDS	15	1 Liter Dispenser
CMW2LT	4	2 Liter Cartridge
SHW2LDP	8	2 Liter Dispenser

See page 10 for additional compatible dispensers

Recommended Dispenser



Cleanse Washroom Manual Dispensers

CODE	DISPENSER NAME	COLOR	SIZE	CASE QTY	TO USE WITH
WRM1LDS	SCJ Professional Cleanse Washroom	White	1 Liter	15	CLR1L, AZU1L, RFW1L, ENGL
WRM2LDP	SCJ Professional Cleanse Washroom	White	2 Liter	8	CLR2LT, AZU2LT, RFW2LT, ENG2LT
TPW1LDS	Proline Transparent White with Chrome Border	Trans	1 Liter	15	Universal for all 1 Liter SCJ Professional cartridges
TPB1LDS	Proline Transparent Black with Chrome Border	Trans	1 Liter	15	Universal for all 1 Liter SCJ Professional cartridges

See page 10 for more dispenser options

1-ECOLOGO® Certified - Product certified to ECOLOGO® UL 2784 Standard for Sustainability for Hand Cleaners for reduced environmental impact. This standard sets metrics for environmental and other criteria, including: materials and packaging; human health and environment; and product performance and labeling. For more information and to view the standard, visit ul.com/et.
2-NSF Rated - This product complies with the NSF International standards for Nonfood Compounds / Handwashing Products (Category Code E1).
3-ECARF Seal of Quality - This product meets the European Centre for Allergy Research Foundation (ECARF) criteria for skin tolerability. For more information go to <http://ecarf-siegel.org/en/about-seal>.
4-Green Seal® Certified - This product meets Green Seal® Standard GS-41A for Hand Cleaners for Institutional Use. The Green Seal® certification represents compliance with criteria designed to achieve leadership levels in sustainability by meeting requirements for product performance, human & environmental toxicity, and product packaging and labeling. For more information and to view the specific standard, visit GreenSeal.org.



QuickView™ Dispenser & Refresh™ FOAM SOAPS



CODE	DISPENSER NAME	COLOR	SIZE	CASE QTY	TO USE WITH
WYHILDS	Kid's Wash	Green	1 Liter	15	Universal for all 1 Liter SCJ Professional cartridges
TPWILDS	Proline Transparent White with Chrome Border	Clear	1 Liter	15	Universal for all 1 Liter SCJ Professional cartridges
TWHILDS	Proline Translucent White with Chrome Border	White	1 Liter	15	Universal for all 1 Liter SCJ Professional cartridges
WHBILDS	Proline Curve White 1 Liter	White	1 Liter	15	Universal for all 1 Liter SCJ Professional cartridges
BLK2LDP	Proline Curve Black 2 Liter Foam	Black	2 Liter	8	For all 2 Liter foam SCJ Professional cartridges
91128	Proline Curve Black 1 Liter	Black	1 Liter	15	Universal for all 1 Liter SCJ Professional cartridges
TBKILDS	Proline Translucent Black with Chrome Border	Black	1 Liter	15	Universal for all 1 Liter SCJ Professional cartridges
TPBILDS	Proline Transparent Black with Chrome Border	Clear	1 Liter	15	Universal for all 1 Liter SCJ Professional cartridges
98123	Stainless Steel	Silver	1 Liter	10	Universal for all 1 Liter SCJ Professional cartridges



Dispensing Stand

CODE	DISPENSER NAME	COLOR	CASE QTY	TO USE WITH
CTDSPSTAND	Countertop Dispenser Stand	Silver	1	All Manual and TF SCJP Dispensers

Note: dispenser sold separately

Stylish and highly efficient TouchFREE dispensers with exceptionally long battery life for wall-mount or counter-mount applications.

- Specifically designed to deliver the right amount of product every time, minimizing over-use and waste
- Integrated with hygienically-sealed cartridges to eliminate mess and provide fresh product every application
- Low maintenance, combining robust and easy-to-clean dispenser surfaces with rapid cartridge replacement

Wall-Mount TF Ultra™

WHERE TO USE:

For use with our range of washroom foam soaps, antibacterial foam soaps and foam hand sanitizers.



Innovative, low energy, infrared sensing technology provides up to 5 years battery life

CODE	DISPENSER NAME	COLOR	CASE QTY	TO USE WITH
TF2WHI	TouchFREE Ultra	White	8	CLR120TF, AZU120TF, RFW120TF,
TF2CHR	TouchFREE Ultra	Black & Chrome	8	AFS120TF, AGB120TF, IFC1TF, ANTI20TF
TF2BLK	TouchFREE Ultra	Black	8	



Counter-Mount CTF Ultra™

WHERE TO USE:

For use with the our range of washroom foam soaps

- Flexible design allows any orientation to guarantee housing in most facilities
- Built-in light indicators notify facilities when refills and batteries need replacing
- Up to 3 years battery life or 90,000 hand washes

CODE	DISPENSER NAME	COLOR	CASE QTY	TO USE WITH
CTF16LC	CTF Ultra	Chrome	4	CLR16LC, AZU16LC



TouchFREE Dispensers

A free-standing TouchFREE dispenser stand with sign and catch tray included (Note: dispenser sold separately).

CODE	DISPENSER NAME	COLOR	CASE QTY	TO USE WITH
TFDISPSTAND	Sanitizer Stand	Silver	1	TF2WHI, TF2CHR, AUTOINFCN, TF2BLK



BioCote Protected *

Biocote silver ion-based technology effectively reduces bacteria, mold and fungi on the surface of Biocote® treated SC Johnson Professional® dispenser buttons within as little as 2 hours and achieves up to 99.99% reduction over a 24 hour period**. Biocote® maintains its antimicrobial protection for the lifetime of the dispenser button and will not wear off, wash off or leach out. Biocote® technology is not a substitute for good hand hygiene practices.

* BioCote® is a registered trademark of Biocote Limited
 ** Efficacy is independently validated by ISO method



Warranted for Life

Dispensers are guaranteed against normal wear and tear, subject to correct installation, usage and dispenser care. Manual dispensers are warranted for their lifetime. Warranty applies only in the USA and to dispensers exclusively using SC Johnson Professional® products. Other terms and conditions apply: warranty.scjp.com

Custom Dispensers

The range of dispensers featured in this product guide has been carefully designed to complement our hand hygiene program.

In addition, our cutting-edge print technology can be combined with a wide variety of component color options to decorate a dispenser that is unique to you.

Our design teams can work with you to create a dispenser that reflects your own identity or specification.

Our exclusive design development and manufacturing process produces permanent decorations that will last the life of the dispenser.

[Click Here to create your custom dispenser at pickandmix.scjp.com](http://pickandmix.scjp.com)





method Foaming Hand Wash Sea Minerals

Foaming Hand Wash

FOAM

WHERE TO USE:

For general industrial and commercial environments.

CODE	CASE QTY	SIZE
327739	6	10oz Pump Bottle
328110	4	28oz Refill

- Premium, nature inspired fragrances
- Biodegradable formula
- [327739] Recyclable pump bottles (minus pumps) made with 100% recycled plastic (PCR)
- Sea minerals is a blend of bergamot, lemon and rosemary with crisp marine notes



method Foaming Hand Wash Sweet Water

Foaming Hand Wash

FOAM

WHERE TO USE:

For general industrial and commercial environments.

CODE	CASE QTY	SIZE
327740	6	10oz Pump Bottle
328111	4	28oz Refill

- Premium, nature inspired fragrances
- Biodegradable formula
- [327740] Recyclable pump bottles (minus pumps) made with 100% recycled plastic (PCR)
- Sweet Water is a light, dewy scent of grapefruit & lemon leaves wrapped in petals of star jasmine & lily of the valley



method Foaming Hand Wash Waterfall

Foaming Hand Wash

FOAM

WHERE TO USE:

For general industrial and commercial environments.

CODE	CASE QTY	SIZE
327742	6	10oz Pump Bottle
328107	4	28oz Refill

- Premium, nature inspired fragrances
- Biodegradable formula
- [327742] Recyclable pump bottles (minus pumps) made with 100% recycled plastic (PCR)
- Waterfall fragrance is an oasis of cool, cascading water lily and soft sandalwood notes



method Gel Hand Wash French Lavender

Gel Hand Wash

GEL

WHERE TO USE:

For general industrial and commercial environments.

CODE	CASE QTY	SIZE
327748	6	12oz Pump Bottle
328115	4	34oz Refill

- Premium, nature-inspired fragrances
- Iconic tear drop design bottle
- [327748] Recyclable pump bottles (minus pumps) made with 100% recycled plastic (PCR)
- French Lavender is an enchanting medley of lavender, bergamot, purple sage & chamomile



method Gel Hand Wash Sweet Water

Gel Hand Wash

GEL

WHERE TO USE:

For general industrial and commercial environments.

CODE	CASE QTY	SIZE
327755	6	12oz Pump Bottle
328104	4	34oz Refill

- Premium, nature-inspired fragrances
- Iconic tear drop design bottle
- [327755] Recyclable pump bottles (minus pumps) made with 100% recycled plastic (PCR)
- Sweet Water is a light, dewy scent of grapefruit & lemon leaves wrapped in petals of star jasmine & lily of the valley



Mrs. MEYER'S Liquid Hand Soap Lavender

Liquid Hand Wash

LIQUID

WHERE TO USE:

For general industrial and commercial environments.

CODE	CASE QTY	SIZE
651311	6	12.5oz Pump Bottle
651318	4	33oz Bottle

- Non-drying soap made with essential oils, aloe vera, olive oil and other thoughtfully chosen ingredients
- Paraben free hand soap that is also made without phthalates or artificial colors
- Cruelty-free formula is not tested on animals
- [651311] Bottle (minus pumps, triggers for the pumps and closures for the refill bottle) made with at least 30% Post-Consumer Plastic



Mrs. MEYER'S Liquid Hand Soap Lemon Verbena

Liquid Hand Wash

LIQUID

WHERE TO USE:

For general industrial and commercial environments.

CODE	CASE QTY	SIZE
651321	6	12.5oz Pump Bottle
651327	4	33oz Bottle

- Non-drying soap made with essential oils, aloe vera, olive oil and other thoughtfully chosen ingredients
- Paraben free hand soap that is also made without phthalates or artificial colors
- Cruelty-free formula is not tested on animals
- [651321] Bottle (minus pumps, triggers for the pumps and closures for the refill bottle) made with at least 30% Post-Consumer Plastic

Click Here for Product Information

Skincare with a premium touch.





Refresh™ AntiBac FOAM

Signature Citrus Fragrance Antimicrobial Foam Handwash

FOAM

WHERE TO USE:

Washrooms where a higher level of hand hygiene is required, e.g. healthcare facilities.

- An Invigorating Citrus fragrance with caring, pleasantly fresh and clean notes to elevate the restroom experience for every day use. Proven to have broad appeal amongst washroom users
- Mild Formulation: Dermatologist tested to verify and confirm this product does not elicit dermal irritation
- Mild preservative: Specially formulated with one of the mildest preservatives to reduce the risk of skin irritation from using this product
- Contains Benzalkonium Chloride to deliver antimicrobial efficacy of 99.99% for a variety of Gram positive and Gram negative bacteria

CODE	CASE QTY	SIZE
ANTIL	6	1 Liter Cartridge
ANTILDS	15	1 Liter Dispenser
ANT120TF	3	1.2 Liter for TF Ultra
ANT2LT	4	2 Liter Cartridge
ANT2LDP	8	2 Liter Dispenser



AgroBac™ PURE FOAM Wash

Perfume-Free & Dye-Free Antimicrobial Foam Hand Soap for Food Handling

FOAM

WHERE TO USE:

For general use and hygienic handwashing in food & catering environments, or any other workplace or public facility where a high standard of hand hygiene is required.

- Antimicrobial foam hand soap with Benzalkonium Chloride to clean the hands and kill many common foodborne bacteria when used as directed
- Perfume-free and dye-free
- Reduces transient bacteria on the hands from touching contaminated surfaces
- Hygienic cartridge

CODE	CASE QTY	SIZE
AGBIL	6	1 Liter Cartridge
ANTILDS	15	1 Liter Dispenser
AGB120TF	3	1.2 Liter for TF Ultra
AGB2LT	4	2 Liter Cartridge
ANT2LDP	8	2 Liter Dispenser



Nonfood Compounds Program Listed E2 157532

1-NSF Rated - This product complies with the NSF International standards for Nonfood Compounds / Antibacterial Handwashing Products (Category Code E2).



In the food industry?
[Click Here](#) to check out all of our products for food service



Kindest Kare® Advanced

Perfume-free and Dye-free Healthcare Personnel Hand Wash

FOAM

WHERE TO USE:

For use in healthcare settings where a higher level of hand hygiene is required.

- Antibacterial foam hand wash with Benzalkonium Chloride
- Complies with 1994 and 2015 FDA proposed requirement for Healthcare Personnel Hand Wash
- Perfume-free and dye-free
- Mild formulation for frequent use

CODE	CASE QTY	SIZE
626461	6	1 Liter Cartridge
155404	15	1 Liter Dispenser
6264312	3	1.2 Liter for TF Ultra
155909	8	1.2 Liter TF Dispenser

Recommended Dispenser



Cleanse Antimicrobial Dispensers

CODE	DISPENSER NAME	COLOR	CASE QTY	TO USE WITH
ANTILDS	SCJ Professional Cleanse Antimicrobial	White	15	ANTIL, AGBIL
ANT2LDP	SCJ Professional Cleanse Antimicrobial	White	8	ANT2LT, AGB2LT

SCJP Cleanse Rating Scale



Estesol®

Hand, Hair & Body Cleaner General Dirt | Grime

Cleanse Rating **2** **LOTION**

WHERE TO USE:

For use in general industrial environments.

- Suitable for use on hands, hair and body to remove general workplace dirt and grime
- Contains Glycerin, a skin moisturizer to help prevent drying and leave the skin feeling smooth after use
- Refreshing and invigorating "rainforest" fragrance, appealing to both males and females

Cleanse Light

CODE	CASE QTY	SIZE
HAB1G	4	1 Gallon Bottle
HAB1L	6	1 Liter Cartridge
SHW1LDS	15	1 Liter Dispenser
HAB2LT	4	2 Liter Cartridge
SHW2LDP	8	2 Liter Dispenser
HAB4LTR	4	4 Liter Cartridge
SHW4LDR	6	4 Liter Dispenser



Estesol® PURE

Hand, Hair & Body Cleaner General Dirt | Grime

Cleanse Rating **2** **LOTION**

WHERE TO USE:

For general industrial and food manufacturing / processing environments.

- A skin hypoallergenic lotion hand, hair and body cleaner to remove industrial dust, dirt and food related soilings
- Perfume-free and dye-free
- Suitable for food facilities
- Contains Glycerin, a skin moisturizer to help prevent drying and leave the skin feeling smooth after use

Cleanse Light

CODE	CASE QTY	SIZE
PUW1L	6	1 Liter Cartridge
SHW1LDS	15	1 Liter Dispenser
PUW2LT	4	2 Liter Cartridge
SHW2LDP	8	2 Liter Dispenser
PUW4LTR	4	4 Liter Cartridge
SHW4LDR	6	4 Liter Dispenser



Recommended Dispenser



Cleanse Hand, Hair & Body Manual Dispensers

CODE	DISPENSER NAME	COLOR	SIZE	CASE QTY	TO USE WITH
SHW1LDS	SCJ Professional Hand, Hair & Body	White	1 Liter	15	CMW1L, HAB1L, PUW1L
SHW2LDP	SCJ Professional Hand, Hair & Body	White	2 Liter	8	CMW2LT, HAB2LT, PUW2LT
SHW4LDR	SCJ Professional Hand, Hair & Body	White	4 Liter	6	HAB4LTR, PUW4LTR

1 - ECOLOGO® Certified - Product certified to ECOLOGO® UL 2845 Standard for Sustainability for Personal Care Products for reduced environmental impact. This standard sets metrics for environmental and other criteria, including: materials and packaging; human health and environment; and product performance and labeling. For more information and to view the standard, visit ul.com/el
2 - NSF Rated - This product complies with the NSF International standards for Nonfood Compounds / Handwashing Products (Category Code E1). This product complies with the NSF International standards for Nonfood Compounds / Hand Lotions/Cleaners-nonfood contact (Category Code E4).
3 - Green Seal® Certified - This product meets Green Seal® Standard GS-41A for Hand Cleaners for Institutional Use. The Green Seal® certification represents compliance with criteria designed to achieve leadership levels in sustainability by meeting requirements for product performance, human & environmental toxicity, and product packaging and labeling. For more information and to view the specific standard, visit GreenSeal.org.



Solopol® Lime

Medium-Heavy Duty Hand Wash Oil | Grease | General Dirt & Grime

Cleanse Rating **3** **LOTION**

WHERE TO USE:

For use in industrial environments to remove medium to heavy soiling.

- Solvent-free hand cleaner with a refreshing light lime fragrance
- Contains natural, non-abrasive and biodegradable cornmeal scrubbing agent easily rinsed away, helping to prevent blocked drains and pipes
- Contains Glycerin, a skin moisturizer to help prevent drying and leave the skin feeling smooth after use

Cleanse Medium-Heavy

CODE	CASE QTY	SIZE
LIM2LT	4	2 Liter Cartridge
HVY2LDB	8	2 Liter Dispenser
LIM4LTR	4	4 Liter Cartridge
HVY4LDB	6	4 Liter Dispenser



Kresto® KWIK-WIPES®

Heavy Duty Hand Cleaning Wipes Oil | Grease | General Grime

Cleanse Rating **4** **WIPES**

WHERE TO USE:

For use without water at the work station and for mobile workers to remove oil, grease and general grime.

- Tough, extra large wipes
- Handy, easy-to-use tub can be used at the work-point for quick cleaning, or on-the-move when working remotely and normal hand washing facilities are not conveniently available
- Contains skin conditioner to help prevent drying, leaving the skin feeling smooth after use
- Citrus fragrance makes the product pleasant to use and leave the skin smelling fresh

Cleanse Heavy

CODE	CASE QTY	SIZE
KKW70W	6	70 Wipes
KKW130W	4	130 Wipes



Solopol® Classic

Heavy Duty Hand Cleaner Oil | Grease | Carbon Black | Lubricants | Water-based Lacquers & Resins

Cleanse Rating **4** **PASTE**

WHERE TO USE:

For use in industrial environments to effectively remove heavy soiling.

- A solvent-free hand cleaner with natural scrubbing agents to remove water-based lacquers, heavy oil and grease
- Contains Astopon® scrubbing agent, which is produced from refined walnut shell powder, a natural source. Easily rinsed away, helping to prevent blocked drains and pipes.
- Specially formulated with one of the mildest preservatives to reduce the risk of skin irritation from using this product

Cleanse Heavy

CODE	CASE QTY	SIZE
SOL2LT	4	2 Liter Cartridge
HVY2LDB	8	2 Liter Dispenser
SOL4LTR	4	4 Liter Cartridge
HVY4LDB	6	4 Liter Dispenser
SOL1G	4	1 Gallon Pump



1 - ECOLOGO® Certified - Product certified to ECOLOGO® UL 2784 Standard for Sustainability for Hand Cleaners for reduced environmental impact. This standard sets metrics for environmental and other criteria, including: materials and packaging; human health and environment; and product performance and labeling. For more information and to view the standard, visit ul.com/el

Solopol[®] GF[™]X

THE NEXT GENERATION OF HEAVY DUTY HAND CLEANER



Solopol[®] GF[™]X

Heavy Duty Foam Cleaner With Grit
Dirt | Grime | Oil | Grease | Carbon Black | Lubricants

Cleanse Rating **4** **FOAM**

WHERE TO USE:

For use in industrial environments to effectively remove heavy soiling such as oil, grease, carbon black, lubricants and general dirt and grime.

- The world's only heavy-duty Power Foam hand cleaner with grit
- Provides up to 42% more hand washes per liter compared to traditional heavy duty hand cleaners
- Contains cornmeal and olive pit scrubbing agents
- The instant foam lather spreads rapidly and easily to emulsify the dirt and grime for thorough and efficient cleaning
- Transforms heavy duty hand cleaning liquid into five times its volume, creating a rich-cream foam

Cleanse Heavy

CODE	CASE QTY	SIZE
GPF3LNA	2	3.25 Liter Cartridge
GPF3LDQ	6	3.25 Liter Dispenser



Cleanse Heavy Duty FOAM Dispenser



CODE	DISPENSER NAME	COLOR	CASE QTY	TO USE WITH
GPF3LDQ	SCJ Professional Heavy Duty FOAM	Black	6	GPF3LNA

1 - ECOLOGO[®] Certified - Product certified to ECOLOGO[®] UL 2784 Standard for Sustainability for Hand Cleaners for reduced environmental impact. This standard sets metrics for environmental and other criteria, including: materials and packaging; human health and environment; and product performance and labeling. For more information and to view the standard, visit ul.com/el
2 - Green Seal[®] Certified - This product meets Green Seal[®] Standard GS-41A for Hand Cleaners for Industrial Use. The Green Seal[®] certification represents compliance with criteria designed to achieve leadership levels in sustainability by meeting requirements for product performance, human & environmental toxicity, and product packaging and labeling. For more information and to view the specific standard, visit GreenSeal.org.



Kresto[®] HERITAGE

Super-Heavy Duty Hand Cleaner
Oil | Grease | Bitumen | Adhesives

Cleanse Rating **5** **LOTION**

WHERE TO USE:

For use in industrial environments to remove difficult and extremely heavy industrial soiling.

- Powerful solvent based hand cleanser
- Natural cornmeal scrubbing agent to provide a highly effective cleansing performance
- Leave the skin feeling refreshed.

Cleanse Super-Heavy

CODE	CASE QTY	SIZE
O9107	4	2 Liter Cartridge
HVY2LDB	8	2 Liter Dispenser
O9104	4	4 Liter Cartridge
HVY4LDB	6	4 Liter Dispenser
O9102	4	1 Gallon Pump



Kresto[®] CLASSIC

Super-Heavy Duty Hand Cleaner
Oil | Grease | Carbon Black | Lubricants | Bitumen

Cleanse Rating **5** **PASTE**

WHERE TO USE:

Industrial environments to remove extremely heavy soiling including ingrained oil, grease, carbon black and lubricants.

- Contains a specialist mild solvent Isohexadecane, a highly refined hydrocarbon solvent with low potential to cause irritation of the skin
- Contains Astopon[®] scrubbing agent, which is produced from refined walnut shell powder, a natural source. Easily rinsed away, helping to prevent blocked drains and pipes.
- An optimized blend of surfactants to create a unique mixed micellar cleaning system which penetrates, lifts and solubilizes a wide range of ingrained oil, grease, carbon black, lubricants, water-based lacquers and resins

Cleanse Super-Heavy

CODE	CASE QTY	SIZE
KCL250ML	12	250ml Tube
KCL2LT	4	2 Liter Cartridge
HVY2LDB	8	2 Liter Dispenser
KCL4LTR	4	4 Liter Cartridge
HVY4LDB	6	4 Liter Dispenser
KCL1G	4	1 Gallon Pump



Kresto[®] CHERRY

Super-Heavy Duty Hand Cleaner
Oil | Grease | Carbon Black | Lubricants | Bitumen

Cleanse Rating **5** **PASTE**

WHERE TO USE:

Industrial environments to remove extremely heavy soiling including ingrained oil, grease, carbon black and lubricants.

- Pleasant cherry fragrance helps neutralize petroleum odor to leave hands smelling fresh and clean
- Contains a specialist mild solvent Isohexadecane, a highly refined hydrocarbon solvent with low potential to cause irritation of the skin
- An optimized blend of surfactants to create a unique mixed micellar cleaning system which penetrates, lifts and solubilizes a wide range of ingrained oil, grease, carbon black, lubricants, water-based lacquers and resins
- Contains Astopon[®] scrubbing agent, which is produced from refined walnut shell powder, a natural source. Easily rinsed away, helping to prevent blocked drains and pipes.

Cleanse Super-Heavy

CODE	CASE QTY	SIZE
KCH2LT	4	2 Liter Cartridge
HVY2LDB	8	2 Liter Dispenser
KCH4LTR	4	4 Liter Cartridge
HVY4LDB	6	4 Liter Dispenser
KCH1G	4	1 Gallon Pump



Recommended Dispenser



Cleanse Heavy Dispensers

CODE	DISPENSER NAME	COLOR	CASE QTY	TO USE WITH
HVY2LDB	SCJ Professional Cleanse Heavy	Black	8	LIM2LT, SOL2LT, 09107, KCL2LT, KCH2LT
HVY4LDB	SCJ Professional Cleanse Heavy	Black	6	LIM4LTR, SOL4LTR, 09104, KCL4LTR, KCH4LTR



Kresto® Cherry WIPES

Super-Heavy Duty Hand Cleaning Wipes
Oil | Paints | Sealants | Grease | Resins

Cleanse Rating 5 **WIPES**

WHERE TO USE:

For use without water at the work station and for mobile workers to remove oil, grease, paints, sealants, resins and general grime.

- Tough, extra large special wipe made from polypropylene with a slightly roughened surface
- Pleasant cherry fragrance helps neutralize petroleum odor to leave hands smelling fresh and clean
- Contains skin conditioner to help prevent drying, leaving the skin feeling smooth after use

Cleanse Super-Heavy

CODE	CASE QTY	SIZE
KCW70W	6	70 Wipes
KCW130W	4	130 Wipes



Kresto® Special Ultra

Specialist Hand Cleaner
Varnish | Resins | Adhesives | Alkyd & Acrylic Paints

Cleanse Rating 5 **PASTE**

WHERE TO USE:

For use in industrial environments including print, paint and body shops, where specialist adherent contaminants are encountered.

- Specialist hand cleaner formulated with ester based solvent to remove very adherent substances
- Contains Astopon® scrubbing agent, which is produced from refined walnut shell powder, a natural source. Easily rinsed away, helping to prevent blocked drains and pipes.
- Uses 100% active ingredients in a clay-thickened matrix, enabling only a small amount of product for effective and economical cleaning

Cleanse Ultra

CODE	CASE QTY	SIZE
KSP250ML	12	250ml Tube
KSP2LT	4	2 Liter Cartridge
ULT2LDB	8	2 Liter Dispenser

Cleanse Ultra Dispenser



Cleanse Ultra Dispensers

CODE	DISPENSER NAME	COLOR	CASE QTY	TO USE WITH
ULT2LDB	SCJ Professional Cleanse Ultra	Black	8	KSP2LT

ALSO TRY

fantastik
MAX

FOR HARD SURFACES



- CUTS GREASE
- CLEANS STAINS
- REMOVES MARKS

Click Here to see our line of fantastik® products



InstantFOAM™ Complete *PURE*

Broad Spectrum Instant Alcohol Hand Sanitizer
Kills 99.999% of many common germs in 15 secs

FOAM

WHERE TO USE:

Idea for use in closed or semi-closed quarters where hand hygiene is critical (e.g. cruise ships, food manufacturing and long-term care).

- Perfume and dye-free, alcohol-based hand sanitizer
- Broad spectrum and highly effective hand sanitizer
- Leaves no sticky residue
- Skin hypoallergenic and non-drying to hands

Sanitize		
CODE	CASE QTY	SIZE
IFC47ML	12	47ml Pump Bottle
IFC400ML	6	400ml Pump Bottle
IFCIL	6	1 Liter Cartridge
IFCITF	3	1 Liter for TF Ultra

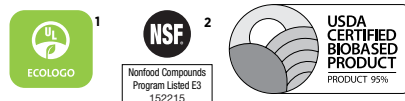

InstantFOAM™ Non-Alcohol *PURE*

Instant Non-Alcohol Hand Sanitizer
Kills 99.99% of many common germs in 30 secs

FOAM

WHERE TO USE:

For areas where alcohol-based/flammable products are a concern, e.g. schools, prisons, health institutions.

- Effective, perfume-free, dye-free non-alcohol based foam hand sanitizer
- Contains skin conditioners to prevent drying of the skin and leaves hands feeling soft and supple

Sanitize		
CODE	CASE QTY	SIZE
55851	12	47ml Pump Bottle
55815	12	400ml Pump Bottle
55857	6	1 Liter Cartridge
AFS120TF	3	1.2 Liter for TF Ultra



1 - ECOLOGO® Certified - This product is certified to meet ECOLOGO® UL 2783 Standard for Instant Hand Antiseptic Products. ECOLOGO® certifications are voluntary, multi-attribute, life cycle based environmental certifications that indicate a product has undergone scientific testing, auditing, or both, to confirm its compliance with such standard. ECOLOGO® UL 2783 Standard sets criteria for product formulation and manufacturing, and human health & environment toxicity. For more information and to view the specific standard, visit UL.com/EL.

2 - NSF Rated - This product complies with the NSF International standards for Nonfood Compounds / Hand Sanitizing Products (Category Code E3).

Recommended Dispenser



Sanitize Dispensers

CODE	DISPENSER NAME	COLOR	CASE QTY	TO USE WITH
SANILDS	Sanitize	White	15	56827, 55857, IFC1L
IFS1LDS	Sanitize (Commercial)	White	15	56827, 55857, IFC1L
AUTOINFCN	Sanitize (Commercial) TouchFREE	White	8	AFS120TF, IFCITF

Try all of our DISINFECTANT PRODUCTS*

LEARN MORE ON PAGE 43

*Use as Directed
Use pesticides safely. Always read label and product information before use.



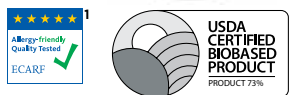

Stokolan Light ^{PURE}

Skin Conditioning Cream
Normal to Dry Skin



WHERE TO USE:

For use by those with moderate skin dryness from daily working in industrial, food handling, healthcare, office and commercial areas.

- Perfume-free and dye-free
- Suitable for food facilities*
- Proven glove compatibility
- Designed for normal to dry skin to absorb and leave no greasy after-feel, encouraging regular use and maintaining healthy skin condition
- Compatible with alcohol-based hand sanitizers

*Product should not come directly into contact with food or items that contain food.

Normal to Dry Skin

CODE	CASE QTY	SIZE
RES100ML	12	100ml Tube
RES1L	6	1 Liter Cartridge
RES1LDS	15	1 Liter Dispenser



SBS® 40

Skin Conditioning Cream
Normal Skin



WHERE TO USE:

For use in industrial and healthcare work areas, offices and public washrooms

- Lightly fragranced conditioning cream
- Non-greasy formula specifically formulated for quick and easy use without leaving greasy, sticky residue on the skin
- Proven glove compatibility

Normal Skin

CODE	CASE QTY	SIZE
SBS30ML	30	30ml Tube
SBS100ML	12	100ml Tube
SBS1L	6	1 Liter Cartridge
RES1LDS	15	1 Liter Dispenser



Stokolan® Hand & Body

Skin Conditioning Lotion
Normal to Dry Skin



WHERE TO USE:

For use by those with normal to dry skin from daily working in industrial, healthcare, office and commercial areas.

- A fast absorbing, easy to apply skin conditioning lotion for use on all areas of the body
- Compatible with alcohol-based hand sanitizers
- Contains skin moisturizer to help prevent drying and leave the skin feeling smooth after use

Normal to Dry Skin

CODE	CASE QTY	SIZE
SBL250ML	12	250ml Bottle

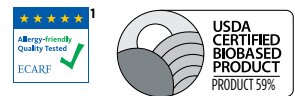

Stokolan® Classic

Enriched Skin Conditioning Cream
Dry | Stressed Skin



WHERE TO USE:

For use in industrial and healthcare environments, especially where employees are prone to dry or stressed skin.

- Clinically proven to support restoration of the skin barrier function when used regularly
- Compatible with alcohol-based hand sanitizers
- High levels of Glycerin and Urea, supports the skin's own moisture system and helps improve skin elasticity
- Contains pharmaceutical-grade Lanolin to help restore natural oils to condition dry and rough skin

Dry & Stressed Skin

CODE	CASE QTY	SIZE
SCL100ML	12	100ml Tube

Recommended Dispenser



Restore Dispenser

CODE	DISPENSER NAME	COLOR	CASE QTY	TO USE WITH
RES1LDS	SCJ Professional Moisturizing Creams	White	15	RES1L, SBS1L

1-ECARF Seal of Quality - This product meets the European Centre for Allergy Research Foundation (ECARF) criteria for skin tolerability. www.ecarf-siegel.org/en/about-seal



FLOOR CARE

FLOOR CARE SYSTEMS • ACCESSORIES • CARPET

SC JOHNSON PROFESSIONAL'S LINE OF FLOOR CARE PRODUCTS AND DISPENSING SYSTEMS ARE DESIGNED TO IMPROVE THE WAY MAINTENANCE PROFESSIONALS WORK. THE MULTI-SURFACE AND EZ CARE FLOOR CARE SYSTEMS ARE ENGINEERED TO HELP SIMPLIFY AND ENHANCE THE USER EXPERIENCE. IT SEAMLESSLY INTEGRATES INTO EXISTING WORKFLOWS AND REQUIRES MINIMAL TRAINING.

FLOOR CARE SYSTEMS

EZ CARE

THE EZ CARE FLOOR CARE SYSTEM SAVES TIME AND LABOR COST VS. CONVENTIONAL STRIPPING.

EZ Care is an integrated floor care system that allows you to achieve a durable, high-gloss finish and eliminates the manual procedure of conventional stripping.

For the first time ever, SC Johnson Professional introduces a patent-pending polymer-blend floor coating that can be easily removed using the EZ CARE Floor Coating Remover and an auto scrubber.

Once the system is installed, you never again need to use conventional stripping chemicals to achieve a lustrous, high-gloss shine.



MULTI-SURFACE FLOOR CARE SYSTEM

THE MULTI-SURFACE FLOOR CARE SYSTEM IS DESIGNED TO IMPROVE THE WAY MAINTENANCE PROFESSIONALS WORK

We engineered the system to help simplify and enhance the user experience. It seamlessly integrates into existing workflows and requires minimal training.

- Complete versatility
- No New Equipment
- No Guesswork
- No Strong Odor

IT'S EVERYTHING WE KNOW, PUT INTO EVERYTHING YOU NEED.™



ACCESSORIES

Make dilution delivery easy with accessories to use along with the TruFill® Dilution Dispensing System.



CARPET

A complete line of carpet care products designed to keep carpets, rugs, and floor coverings in public spaces looking their best and leaving a clean, fresh scent.

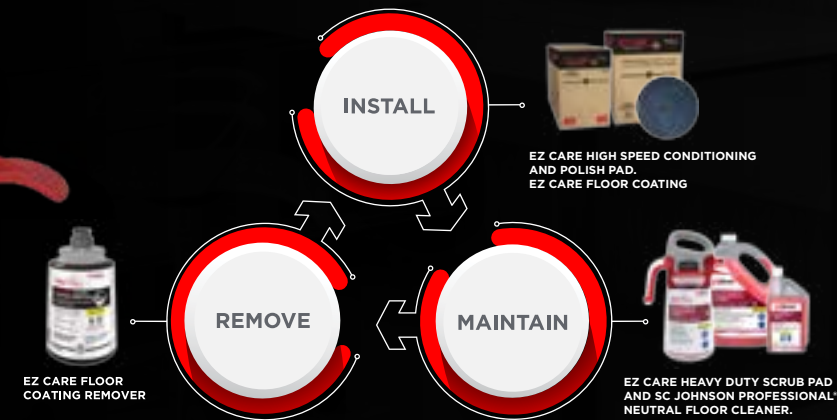

A REVOLUTION IN COMMERCIAL FLOOR CARE.
SIMPLY INSTALL - MAINTAIN - REMOVE

TRUFILL

QUICK-CHANGE

Lock cartridge into reusable TruFill® dispenser head



QUICK CONNECT

Attach quick-connect hose to TruFill® dispenser head



FILL & GO

Hang on bucket or auto scrubber; turn on water source

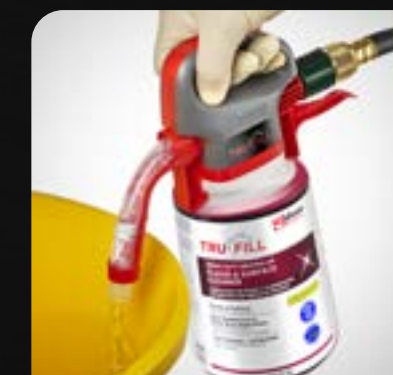

EZ CARE FLOOR COATING

Highly repairable finish provides excellent resistance to scuffs, black heel marks and embedded dirt

- Suitable for a variety of substrates
- Up to 4 coats to achieve a durable high gloss appearance even in high traffic areas
- Goes on smoothly and evenly with any application method

CODE	SIZE	IN-USE GALLONS	PH	DENSITY	FRAGRANCE	SHELF LIFE	COVERAGE
300599 (Bag in Box)	2 Gal (256 fl. oz.)	Ready-to-use	8.2	1.035g/cm ³	Fresh	3 years	Up to 10,000 sq. ft. (929m ²)
300827 (Bag in Box)	5 Gal (640 fl. oz.)	Ready-to-use	8.2	1.035g/cm ³	Fresh	3 years	up to 25,000 sq. ft (2,323m ²)



EZ CARE HIGH SPEED CONDITIONING AND POLISH PAD

Patent pending pad technology prepares the floor for application of finish resulting in a high gloss shine

- Smooths and conditions the floor prior to finish application
- Contributes to a durable high-gloss shine with fewer coats
- Improves the condition and appearance of the floor over time
- Available in two common sizes - (20" and 27")
- Up to 25,000 sq. ft. per pad

CODE	QTY	QTY	SIZE
311182	EZ CARE High Speed Conditioning and Polish Pad 20"	2	20"
311184	1 EZ CARE High Speed Conditioning and Polish Pad 27"	2	27"



EZ CARE HEAVY DUTY SCRUB PAD

- Effectively removes scuffs, scratches and black heel marks-reducing burnishing and maintaining the floor's high gloss appearance
- DUAL-PURPOSE PAD cleans and shines in the same step
- Red side easily adheres to equipment
- Gray side for more abrasive cleaning of coated surfaces
- Long-lasting performance - up to 250,000 sq.-ft.
- Available in four common sizes - (13", 16", 17" and 20")
- Up to 250,000 sq. ft. per pad

CODE	QTY	QTY	SIZE
311174	EZ CARE Heavy Duty Scrubbing Pad 13"	5	13"
319310	EZ CARE Heavy Duty Scrubbing Pad 16"	5	16"
311183	EZ CARE Heavy Duty Scrubbing Pad 17"	5	17"
311181	EZ CARE Heavy Duty Scrubbing Pad 20"	5	20"



TRUFILL® EZ CARE FLOOR COATING REMOVER

Groundbreaking cleaner technology compatible with an auto scrubber.

- Liquify EZ Care Floor Coating for safe, fast removal of up to four coats in one pass.
- Eliminates conventional manual stripping.
- Increases productivity, slashing the time and labor needed for a full removal and recoat.

CODE	DESCRIPTION	SIZE	IN-USE GALLONS	PH (dilution)	DENSITY	FRAGRANCE	SHELF LIFE
300823	TruFill® EZ Care Floor Coating Remover Refill	2L	Up to 30 per cartridge	11.3	8.25g/cm ³	Fresh	2 years
300826	TruFill® EZ Care Floor Coating Remover Starter Pack	2L (plus 1 dispenser)	Up to 30 per cartridge	11.3	8.25g/cm ³	Fresh	2 years

Also try our **HEAVY DUTY NEUTRAL pH FLOOR & SURFACE CLEANER**



[Click Here](#) for more product information

[Click Here](#) for dilution rates and sq. -ft. coverage information



Hyper Concentrate Floor Stripper

WHERE TO USE:

A variety of flooring types such as vinyl composite, vinyl asbestos, 100% sheet vinyl, terrazzo, rubber, granite, brick and slate.

- High performance concentrate for fast, efficient removal of most water-based polymer floor finishes
- No flood rinse required

CODE	QTY	SIZE	DILUTION RATIO	PH (CONCENTRATE)	PH (DILUTION)	DENSITY	FRAGRANCE	SHELF LIFE	IN USE VOLUME
680076 (Bag in Box)	1	2 Gallons (256 fl. oz.)	1:8 - 1:24	12.5+	11.54	1.029g/cm ³ at 27.5°C	Low Odor	4 years	Makes up to 50 gallons
680078 (Quart)	6	1 Quart (32 fl. oz.)	1:8 - 1:24	12.5+	11.54	1.029g/cm ³ at 27.5°C	Low Odor	4 years	Makes up to 25 quarts per bottle

[Click Here](#) for dilution rates and sq. -ft. coverage information

Heavy Duty Neutral pH Floor & Surface Cleaner

WHERE TO USE:

A variety of flooring types such as vinyl composite, vinyl asphalt, vinyl asbestos, 100% sheet vinyl, terrazzo, rubber, linoleum, marble, granite, concrete and sealed wood floors.

- Specially formulated cleaning concentrate for daily maintenance of high traffic floor surfaces and/or scrub/recoat applications

CODE	QTY	SIZE	DILUTION RATIO	PH (CONCENTRATE)	PH (DILUTION)	DENSITY	FRAGRANCE	SHELF LIFE	IN USE VOLUME
680081 (Squeeze & Pour)	6	1 Quart (32 fl. oz.)	1:128-1:512	8.53	7.35	1.024g/cm ³	Fresh	4 years	Makes up to 128 gallons
680079 (Gallon)	4	1 Gallon (128 fl. oz.)	1:128-1:512	8.83	7.35	1.024g/cm ³	Fresh	4 years	Makes up to 513 quarts per bottle

INCOMPATIBLE MATERIALS: Do not mix with strong acids, bleach or any other cleaners.

TruFill® Heavy Duty Neutral pH Floor & Surface Cleaner

WHERE TO USE:

A variety of flooring types such as vinyl composite, vinyl asphalt, vinyl asbestos, 100% sheet vinyl, terrazzo, rubber, linoleum, marble, granite, concrete and sealed wood floors.

- Specially formulated cleaning concentrate for daily maintenance of high traffic floor surfaces
- Makes up to 271 gallons per cartridge

CODE	DESCRIPTION	QTY	SIZE	COLOR	DILUTION RATIO	PH (DILUTION)	DENSITY	FRAGRANCE	SHELF LIFE
684501	TruFill® Concentrate Starter Pack	2 (plus 2 dispensers)	2L	Red	1:512	7.35	1.024g/cm ³	Fresh	4 years
684502	TruFill® Concentrate Cartridge	2	2L	Red	1:512	7.35	1.024g/cm ³	Fresh	4 years

INCOMPATIBLE MATERIALS: Do not mix with strong acids, bleach or any other cleaners.



1- ECOLOGO® Certified - This product is certified to meet ECOLOGO UL 2784 Standard for Sustainability for Hand Cleaners. ECOLOGO® certifications are voluntary, multiattribute, life cycle based environmental certifications that indicate a product has undergone scientific testing, auditing, or both, to confirm its compliance with such standard. ECOLOGO UL 2784 Standard sets criteria for product formulation and manufacturing, and human health & environment toxicity. For more information and to view the specific standard, visit UL.com/EL.



FAST, EFFICIENT REMOVAL LOW-ODOR FORMULATION

ONE STRIPPER

Fast acting hyper-concentrated formula.

- Strip up to 10 coats of SC Johnson Professional® Multi-Surface Finish & Sealer in one pass.
- Range of dilutions from 1:8 to 1:24 to match removal requirement.
- No flood rinse needed.
- Low-odor formulation allows for application virtually anytime, anywhere without interfering with facility operations.

Available in a 2 Gal Bag in Box, 32 oz bottle.



DURABLE FLEXIFILM TECHNOLOGY™

ONE FINISH

Patent-pending FlexiFilm Technology™ is an extremely tough finish that resists cracks, haze, dirt, scuffs and black heel marks.

- Exhibits aggressive adhesion on most flooring substrates.
- Excellent reparability and buff response with all types of pads and UHS machines.
- Eliminates need for separate sealers, spray buffs and maintainers.

Available in a 5 Gallon Bag in Box and 1 Gallon Bottle.



LOW FOAMING, LOW RESIDUE CLEANER

ONE CLEANER

Effective across a range of dilutions, it eliminates the need for multiple floor cleaners and is ideal for daily cleaning and deep scrub.

- High performing, multi-use, neutral pH formula cleans without leaving a residue.
- Range of dilutions from 1:128 for deep cleaning to 1:512 for daily maintenance.
- Low-foaming formulation reduces auto scrubber downtime due to recovery tank foaming. May be used at 1:32 for degreasing.
- Non-dulling formula has outstanding gloss retention.
- Rinses cleanly. May be used on multiple substrates.

Available in a 32 oz. Squeeze & Pour bottle, 1 Gallon Bottle, TruFill Cartridge.



RTU Multi-Surface Floor Finish Plus Sealer

WHERE TO USE:

Most flooring substrates including VCT, sheet vinyl, terrazzo, rubber, linoleum, honed marble or granite, and unglazed ceramic.

- Patent pending FlexiFilm Technology™ creates an extremely tough highly repairable finish that exhibits aggressive adhesion on most flooring substrates
- Excellent resistance to scuffs, black heel marks, and dirt embedment, gloss level is quickly restored with multi-speed buffing
- Versatile finish that is user-friendly, easy to apply and easy to strip, with a light fresh scent

CODE	QTY	SIZE	DILUTION RATIO	PH	DENSITY	FRAGRANCE	SHELF LIFE	COVERAGE
680075 (Gallon)	4	1 Gal (128 fl. oz.)	Ready-to-use	8.18	1.0312g/cm ³	Fresh	3 years	Up to 3,000 sq. ft. (278.7 m ²) per gallon
680074 (Bag in Box)	1	5 Gal (640 fl. oz.)	Ready-to-use	8.18	1.0312g/cm ³	Fresh	3 years	Up to 15,000 sq. ft. (1393.5 m ²) per 5 gallon BIB

INCOMPATIBLE MATERIALS: Do not mix with strong acids, bleach or any other cleaners.

1- ECOLOGO® Certified - This product is certified to meet ECOLOGO UL 2784 Standard for Sustainability for Hand Cleaners. ECOLOGO® certifications are voluntary, multiattribute, life cycle based environmental certifications that indicate a product has undergone scientific testing, auditing, or both, to confirm its compliance with such standard. ECOLOGO UL 2784 Standard sets criteria for product formulation and manufacturing, and human health & environment toxicity. For more information and to view the specific standard, visit UL.com/EL.



TRUFILL® HOSE HOOK-UP KIT - STANDARD



WHERE TO USE:
Use along with the TruFill® Dispensing System head and cartridges.

- Hook-up directly to your water source, and attach to the TruFill® dispenser head with the quick connect adapter

CODE	DESCRIPTION	QTY	SIZE	FILL RATE
684503	TruFill® Hose Hook-Up Kit	12	3/4 in. diameter x 6 ft.	Up to 4 GPM

TRUFILL® HOSE HOOK-UP KIT WITH ON/OFF VALVE & PRESSURE BLEEDER



WHERE TO USE:
Use along with the TruFill® Dispensing System head and cartridges.

- Hose Hook-up kit includes a convenient on/off valve at the dispensing end while a pressure bleeder maintains the integrity of any vacuum breaker you have installed at the water source (vacuum breaker provides backflow protection for the water system)

CODE	DESCRIPTION	QTY	SIZE	FILL RATE
684498	Hose Hook-up with on/off & pressure bleeder	12	3/4 in. diameter x 6 ft.	Up to 4 GPM

TRUFILL® DISPENSER HEADS



WHERE TO USE:
Used along with the TruFill® cartridges the head blends the concentrates with water to provide worry-free dilution delivery.

- Complete the TruFill® Dispensing System with the easy-to-use, reusable dispenser head

CODE	DESCRIPTION	QTY
309422	Bulk Pack TruFill® Dispenser Heads	50

CARPET PRE-SPRAY AND BONNET CLEANER



- A unique formulation that effectively transfers most soils from carpet fiber to cleaning pad without leaving the carpet tacky
- Excellent for extending periods between full-scale carpet cleaning
- Safe for use on stain resistant carpet
- May also be used as a Ready-to-Use general purpose spotter

CODE	DESCRIPTION	QTY	SIZE	DILUTION RATIO	PH (DILUTION)	DENSITY	FRAGRANCE	SHELF LIFE	IN-USE
680082	Concentrate	4	1 Gallon (128 fl. oz.)	1:4 - 1:16	8.5	1.01g/cm ³	Fresh	3 years	Up to 17 Gallons per bottle

INCOMPATIBLE MATERIALS: Do not mix with strong acids, bleach or any other cleaners.

READY-TO-USE CARPET SPOTTER



- An excellent, general carpet spotter that is also effective against tougher stains such as paint, oil and grease
- High performance formula surrounds, lifts and suspends soils for quick removal of stains, without leaving the carpet tacky
- Safe for use on stain resistant carpet

CODE	DESCRIPTION	QTY	SIZE	DILUTION RATIO	PH (RTU)	DENSITY	FRAGRANCE	SHELF LIFE
680085	Trigger Sprayer	6	1 Quart (32 fl. oz.)	Ready-to-use	9.5	1.01g/cm ³	Fresh	3 years

INCOMPATIBLE MATERIALS: Do not mix with strong acids, bleach or any other cleaners.

1-ECOLOGO® Certified - This product is certified to meet ECOLOGO UL 2784 Standard for Sustainability for Hand Cleaners. ECOLOGO® certifications are voluntary, multiattribute, life cycle based environmental certifications that indicate a product has undergone scientific testing, auditing, or both, to confirm its compliance with such standard. ECOLOGO UL 2784 Standard sets criteria for product formulation and manufacturing, and human health & environment toxicity. For more information and to view the specific standard, visit UL.com/EL.

Check out our **FABRIC & AIR CARE PRODUCTS**

SEE **PAGE 44**





HARD SURFACE CARE

TRUSHOT 2.0® • GLASS • MULTI-SURFACE • KITCHEN • RESTROOM • DISINFECTANTS

A COMPLETE LINE OF HARD SURFACE CLEANERS IN CONCENTRATE AND READY-TO-USE OPTIONS FOR GLASS, RESTROOM, AND MULTI-SURFACE APPLICATIONS.



TRUSHOT 2.0®



GLASS

Windex® Glass & Multi-Surface Cleaners
Windex® Ammonia-Free



KITCHEN

fantastik® Max Oven and Grill
Drano®



MULTI-SURFACE

fantastik® Max Power Cleaner
Pledge®
method® All Purpose Cleaners
Mrs. Meyers® Clean Day All Purpose Cleaners

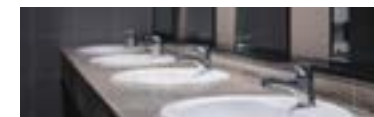

RESTROOM



DISINFECTANTS

fantastik® Multi-Surface Disinfectant Degreaser
Windex® Multi-Surface Disinfectant Sanitizer Cleaner
Scrubbing Bubbles®
Quaternary Disinfectant Squeeze and Pour

DURABLE TRIGGER SPRAYER

Tested to last up to **250,000** trigger pulls

HIGH OUTPUT TRIGGER
DELIVERS 1.0CC OF DILUTED SOLUTION

ON-BOARD 296ML WATER RESERVOIR

UP TO **300 TRIGGER PULLS**
BEFORE REFILLING

FILL AT ANY WATER SOURCE

TRAIN CLEANING CREWS IN MINUTES

RUGGED BOTTLE CONSTRUCTION

WITHSTANDS **6 FT. DROP TEST**

SPILL-FREE CARTRIDGES

EASILY SNAP INTO PLACE

COLOUR-CODED, EASY-TO-READ CARTRIDGES

*deliver from **13 to 43** in-use litre equivalents



CLICK
Durable Snap-In Technology



FILL
Refill at any water source



CLEAN
Portable, lightweight comfort*



TRUSHOT 2.0® TRIGGER DISPENSER

- Will withstand repeated 6 ft. drops, and the trigger has been tested to last more than 250,000 pulls
- The on-board water reservoir holds 10 fl. oz. and lasts 300 trigger pulls before refilling
- Portable, lightweight, and comfortable

CODE	SIZE	QUANTITY/PACK	IN-USE QUARTS
311981	10oz. (296mL)	4	N/A

Works with all TruShot 2.0™ concentrate cartridges.



TRUSHOT 2.0® MULTI-SURFACE, RESTROOM CLEANER AND DISINFECTANT

- Effective against a broad spectrum of bacteria, viruses, fungi and inhibits the growth of mold and mildew
- TruShot 2.0® Multi-Surface, Restroom Cleaner & Disinfectant can be used on washable hard, non-porous surfaces of toilets, tubs, tile, walls, doorknobs, garbage cans, exterior appliances, tables, chairs, desks and countertops
- Sanitizes 99.9% of bacteria in 15 seconds on hard, non-porous, non-food contact surfaces

CODE	DESCRIPTION	QTY	SIZE	COLOR	PH	PH (DILUTION)	DENSITY	FRAGRANCE	SHELF LIFE	IN-USE QUARTS
315385	Restroom Disinfectant	4	10oz. (296mL)	Clear	12.5	11	1.00g/cm ³	Fresh	2 years	10 oz. concentrate = up to 28 in-use quarts



TRUSHOT 2.0® HOSPITAL CLEANER AND DISINFECTANT

- Effective against a broad spectrum of bacteria, viruses, fungi and inhibits the growth of mold and mildew
- For use on washable hard, non-porous surfaces of: countertops, stainless steel, sinks, tubs, doorknobs, floors, walls, garbage cans, chairs, cabinets and tables
- One-step spray and wipe virucide and disinfectant

CODE	DESCRIPTION	QTY	SIZE	COLOR	PH	PH (DILUTION)	DENSITY	FRAGRANCE	SHELF LIFE	IN-USE QUARTS
315387	Hospital Disinfectant	4	10oz. (296mL)	Clear	12.5	11	1.00g/cm ³	No Fragrance	2 years	10 oz. concentrate = up to 15 in-use quarts



GLASS & MULTI-SURFACE CLEANER

- Ideal for daily cleaning of a variety of surfaces including glass, windows, mirrors, aluminum, and walls
- Streak Free with a Clean Fresh Scent
- Removes dirt, grease, oils, dust and grime



CODE	DESCRIPTION	QTY	SIZE	COLOR	PH	PH (DILUTION)	DENSITY	FRAGRANCE	SHELF LIFE	IN-USE QUARTS
315272	Glass & Multi-Surface Cleaner	4	10oz. (296mL)	Clear	7.2	7.4	1.063g/cm ³	fruity, floral - Fresh	4 years	10 oz. concentrate = up to 43 in-use quarts



RESTROOM CLEANER

- Effective cleaning of toilets, tile, tubs, walls, sinks, faucets, countertops, glass and glass shower doors
- Penetrates to remove tough soap scum, hard water, limescale, dirt, grime and oils



CODE	DESCRIPTION	QTY	SIZE	COLOR	PH	PH (DILUTION)	DENSITY	FRAGRANCE	SHELF LIFE	IN-USE QUARTS
315384	Restroom Cleaner	4	10oz. (296mL)	Clear	1.72	2.8	1.101g/cm ³	fruity, floral - Fresh	4 years	10 oz. concentrate = up to 18 in-use quarts



POWER CLEANER AND DEGREASER

- Effectively removes adhesives, oils, grease, baked-on oven soils, dirt and grime
- Ideal for a variety of hard non-porous surfaces
- Powerful non-butyl, alkaline formulation with soil-lifting surfactants for exceptional cleaning



CODE	DESCRIPTION	QTY	SIZE	COLOR	PH	PH (DILUTION)	DENSITY	FRAGRANCE	SHELF LIFE	IN-USE QUARTS
315386	Power Cleaner & Degreaser	4	10oz. (296mL)	Clear	14	11.3	1.03g/cm ³	fruity, floral - Fresh	4 years	10 oz. concentrate = up to 13 in-use quarts



TRUSHOT 2.0® STARTER PACK

- Great for smaller offices, convenience stores, pharmacies or any location where task cleaning by an occupant is required

CODE	SIZE	IN-USE QUARTS
323564	11 3/4" x 6 1/16" x 5 7/8"	TruShot 2.0® Starter Pack 4 chemistries (TruShot 2.0® Glass & Multi-Surface Cleaner, Restroom Cleaner, Power Cleaner & Degreaser & Multi-Surface, Restroom Cleaner & Disinfectant + 1 Trigger)



TRUSHOT 2.0 MOBILE UTILITY BELT

- 1 - 8" x 11" Trigger holder
- 4 - 5" x 8" cartridge bags
- 1 - 2" x 49" Velcro nylon belt
- (fits 43" - 44" waist / hip sizes)

CODE	DESCRIPTION	QUANTITY/PACK
TSBELT	Mobile Utility Belt	12" x 12" 8.5" 10 Belts per Case

TruShot 2.0® triggers and cartridges sold separately.

1-ECOLOGO® Certified - This product is certified to meet EcoLogo UL 2759 Standard for Hard Surface Cleaners. EcoLogo certifications are voluntary, multi-attribute, life cycle based environmental certifications that indicate a product has undergone scientific testing, auditing, or both, to confirm its compliance with such standard. EcoLogo UL 2759 Standard sets criteria for product formulation and manufacturing, and human health & environment toxicity. For more information and to view the specific standard, visit UL.com/EL.

2-NSF® Certified - This product complies with the NSF International standards (Category Code C1) for Nonfood Compounds / Nonprocessing Area Products.

*check product information sheets for in-use quart equivalency

sc Johnson
PROFESSIONAL
A family company®
DISINFECTANT CLAIMS

	TruShot 2.0® Multi-Surface, Restroom Cleaner & Disinfectant	TruShot 2.0® Hospital Cleaner & Disinfectant	Quaternary Disinfectant Cleaner, 680066
EPA Registration Number	6836-348-89900	6836-348-89900	6836-78-89900
ACTIVE INGREDIENT	•	•	•
Quaternary	•	•	•
FORMULATION			
Deodorizer	•	•	•
Fungicidal	•	•	•
Mildewstatic	•	•	•
Virucidal	•	•	•
Sanitizer	•	•	•
EPA's List N: Disinfectants for Use Against SARS-CoV-2 (COVID-19)	•	•	•
EPA's List Q: Disinfectants for use against Monkeypox virus	•	•	•
CLAIMS	CONTACT TIMES IN MINUTES		
BACTERIA:			
Pseudomonas aeruginosa (Pseudomonas)	3	3	10
Salmonella enterica (Salmonella)	3	3	10
Acinetobacter baumannii			10
Burkholderia cepacia			10
Campylobacter jejuni			10
Corynebacterium ammoniagenes			10
Staphylococcus aureus (Staph)	3	3	10
Enterobacter aerogenes at 1:64 dilution		3	10
Enterobacter cloacae NDM-1 positive			10
Enterococcus faecalis (Enterococcus)	3	3	10
Enterococcus faecalis Vancomycin resistnat (VRE)	3	3	10
Escherichia coli (E. coli)	3	3	10
Escherichia coli O157:H7	3	3	
Escherichia coli, New Delhi Metallo-Beta Lactamase (NDM-1)			10
ESBL Escherichia coli (Extended spectrum beta-lactamase producing E. coli)	3	3	10
Klebsiella pneumoniae (Klebsiella)	3	3	10
Klebsiella pneumoniae - NDM-1 positive			10
Klebsiella pneumoniae, Carbapenem-resistant	3	3	
Listeria monocytogenes	3	3	10
Salmonella schottmuelleri			10
Salmonella typhi			10
Serratia marcescens at 1:64 dilution		3	10
Shigella dysenteriae (Shigella)	3	3	10
Shigella flexneri serotype 1B	3	3	
Staphylococcus aureus - Community Associated Methicillin-Resistant (CA-MRSA) (NRS384) (USA300)	3	3	
Staphylococcus aureus - Methicillin-Resistant (MRSA)	3	3	10
Staphylococcus aureus - Community Associated Methicillin-Resistant (CA-MRSA) (NRS123) (USA400)	3	3	10
Staphylococcus aureus - Multi-Drug Resistant	3	3	10
Staphylococcus aureus - Vancomycin Intermediate Resistant			10
Streptococcus pyogenes (Strep)	3	3	10
Legionella pneumophila	10	10	10
Vibrio cholerae			10
VIRUS:			
SARS-Related Coronavirus 2 (cause of COVID-19)	1	1	1
Influenza Type A / H3N2 (Influenza)	1	1	1
Influenza Type A / Brazil			1
Influenza Type A Virus (H7N9)			1
HIV-1	1	1	1
Hepatitis B Virus (HBV)	3	3	10
Hepatitis C Virus (HCV)	3	3	10
Herpes Simplex Virus Type 1	3	3	10
Herpes Simplex Virus Type 2	3	3	10
Human Coronavirus	3	3	1
Respiratory Syncytial Virus (RSV)	3	3	10
Rotavirus	3	3	10
Vaccinia		3	10
SARS Associated Coronavirus (SARS) (cause of Severe Acute Respiratory Syndrome)	10	10	10
Enterovirus D68 - at 1:64 dilution		5	
Norwalk Virus (Norovirus) (Feline Calicivirus) - at 1:64 dilution		5	10
FUNGI:			
Aspergillus fumigatus			10
Aspergillus niger			10
Candida albicans	3	3	
Trichophyton interdigitale (the Athlete's Foot Fungus)	3	3	10
SANITIZER:			
Staphylococcus aureus	15s		1
Staphylococcus aureus-MRSA	15s		
Enterobacter aerogenes (Enterobacter) (ATCC 13048)	15s		
Listeria monocytogenes	15s		
Klebsiella pneumoniae	15s		1



Windex® Glass & Multi-Surface Cleaners

WHERE TO USE:

Works on surfaces such as stainless steel, chrome, mirrors, tile, plastic, laminate, safety shields (tested against Plexiglas® MC and G-Grade acrylic sheet) and other surfaces. Refer to manufacturer's cleaning recommendation prior to use. Plexiglas® is a registered trademark of Arkema France.

- Streak-free shine
- Makes cleaning glass and other hard surfaces fast and easy

Glass Care

CODE	CASE QTY	SIZE
322338	8	32oz Trigger
696503	4	1 Gallon
696502	1	5 Gallon
333813	6	19.7oz Aerosol Can
327171	4	4 Capped Bottles with 2 Triggers



Fantastik MAX Oven & Grill Cleaner

WHERE TO USE:

Formulated for food service and commercial applications. Use on broilers, fryers, grills, griddles, splash panels and ventilating hoods.

- Trigger bottle's wide foaming spray quickly saturates surface for fast cleaning
- Use trigger inside and outside of ovens plus surrounding surfaces
- Product complies with the NSF International standards for Nonfood Compounds / Degreaser/ Carbon Remover Products (Category Code A8)
- Kosher Certified
- Pleasant Scent

Kitchen

CODE	CASE QTY	SIZE
323562	8	32oz Spray Bottle
315531	6	20oz Aerosol Can



Drano Pro Strength Max Gel Clog Remover

WHERE TO USE:

For use in all areas of your facility where you experience tough drain clogs such as kitchens and restrooms.

- Works fast to clear clogged drains and restore them to a free-flowing state
- Pours through standing water and works great on hair clogs, slow drains and pipe build up
- NSF L1 Certified
- Product complies with the NSF International Standards for Nonfood Compounds / General Sewer/Drain Cleaners (Category Code L1)

Kitchen

CODE	CASE QTY	SIZE
696642	4	128oz Gallon Bottle





Windex® Ammonia-Free Multi-Surface Streak-Free Cleaner

WHERE TO USE:

Works on surfaces such as stainless steel, chrome, mirrors, tile, plastic, laminate, safety shields (tested against Plexiglas® MC and G-Grade acrylic sheet) and other surfaces. Refer to manufacturer's cleaning recommendation prior to use. Plexiglas® is a registered trademark of Arkema France.

- Windex® Ammonia-Free Multi-Surface Streak-Free Cleaner offers the famous Windex® streak-free shine with a refreshing scent

Hard Surface Care		
CODE	CASE QTY	SIZE
322381	8	32oz Trigger
697262	4	1 Gallon



Polish & Shine Multi-Surface Furniture Spray

WHERE TO USE:

Safe to use only on finished, sealed surfaces (stainless steel, quartz, marble, sealed leather, sealed wood surfaces and more). One product to shine multiple surfaces.

- Improves the appearance of most hard surfaces by removing dust and fingerprints and providing a protective, glossy coating without leaving a waxy buildup
- This product complies with the NSF International standards for Nonfood Compounds / Nonprocessing Area Products (Category Code C1)
- Does more than polish wood furniture

Multi-Surface		
CODE	CASE QTY	SIZE
301168	6	14.2oz Aerosol Can



Power Cleaner

WHERE TO USE:

Specially formulated to dissolve grease, oil, grime and dirt. Remove: ink, crayon, marker, adhesive stickers, heel marks on hard, non-porous surfaces. Light pleasant scent.

- High-powered performance
- An all-purpose problem solver that is specially formulated to dissolve grease, grime and dirt
- Product complies with the NSF International standards for Nonfood Compounds / Nonprocessing Area Products (Category Code C1)
- Kosher Certified

Hard Surface Care		
CODE	CASE QTY	SIZE
323563	8	32oz Spray Bottle



Moisturizing Oil Furniture Cleaner Aerosol

WHERE TO USE:

Safe to use only on finished, sealed surfaces (wood, leather, laminate).

- Conditioning formula that nourishes, protects, and revitalizes the appearance of wood for lasting, healthy radiance that makes it feel like new again

Multi-Surface		
CODE	CASE QTY	SIZE
697264	6	14.2oz Aerosol Can



Everyday Clean Multi-Surface pH Balanced Cleaner

WHERE TO USE:

Works on most hard, non-porous surfaces such as: chrome, electronics, glass, laminate, mirrors, plastic, sealed granite, sealed marble, sealed quartz, sealed wood, stainless steel, wood laminate and more. Gently cleans 101 surfaces.

- Designed to tackle tough messes, but is gentle enough for daily use
- Formula gently cleans most hard surfaces by removing messes and dust without damaging surfaces or leaving frustrating streaks or residue
- Leaves a fresh citrus scent

Multi-Surface		
CODE	CASE QTY	SIZE
336283	6	25oz Spray Bottle

Also check out our

HEAVY DUTY NEUTRAL pH FLOOR & SURFACE CLEANER

PATENTED LOW FOAM, LOW RESIDUE FLOOR & SURFACE CLEANER

- VARIETY OF SURFACES
- DAILY CLEANING OR DEEP SCRUB APPLICATIONS
- REDUCE THE NEED TO BURNISH WHEN USED WITH THE EZ CARE HEAVY-DUTY SCRUB PAD





RTU Calcium Lime Rust Remover

WHERE TO USE:

Metal and Plastic Surfaces. Do not use on any surface that can be damaged by acidic materials. Many surfaces are not resistant to acid. When using this product, apply first to a small area to determine its suitability. Always rinse thoroughly.

- Formulated to effectively remove calcium, lime, rust, hard water film, iron stains and other scale from metal and plastic surfaces.

CODE	DESCRIPTION	QTY	SIZE	DILUTION RATIO	PH (RTU)	DENSITY	FRAGRANCE	SHELF LIFE
680096	Ready-to-Use Trigger	12	1 Quart (32 fl. oz.)	Ready-to-use	2	1.005g/cm ³	Fresh	2 years

INCOMPATIBLE MATERIALS: Do not mix with strong acids, bleach or any other cleaners.



RTU Acid Toilet Bowl Cleaner

WHERE TO USE:

The thick formula coats toilet bowl surface.

- Quickly eliminates rust, lime and uric acid deposits
- Will not harm septic tanks.

CODE	DESCRIPTION	QTY	SIZE	DILUTION RATIO	PH (RTU)	DENSITY	FRAGRANCE	SHELF LIFE
680058	Angle-Neck Squeeze Bottle	12	1 Quart (32 fl. oz.)	Ready-to-use	<1	1.045g/cm ³	Floral	2 years

INCOMPATIBLE MATERIALS: Do not mix with strong acids, bleach or any other cleaners.



RTU Non-Acid Bowl AND BATHROOM Cleaner

WHERE TO USE:

Designed specifically for institutional cleaning and disinfection in nursing homes, hospitals, institutions, offices, homes, schools, hotels and motels.

- One-step cleaner disinfectant
- Cleans soap scum and hard water films

CODE	DESCRIPTION	QTY	SIZE	DILUTION RATIO	PH (RTU)	DENSITY	FRAGRANCE	SHELF LIFE
680057	Ready-to-Use Trigger	12	1 Quart (32 fl. oz.)	Ready-to-use	10.5	1.010g/cm ³	Fresh	3 years

INCOMPATIBLE MATERIALS: Do not mix with strong acids, bleach or any other cleaners.



RTU Crème Cleanser

Cleans and deodorizes restroom fixtures, glazed porcelain, ceramic tile and fiberglass. Excellent for removing stubborn spots, build-ups, hard water deposits, soap scum and more.

CODE	DESCRIPTION	QTY	SIZE	DILUTION RATIO	PH (RTU)	DENSITY	FRAGRANCE	SHELF LIFE
680097	Ready-to-Use Carafe	12	1 Quart (32 fl. oz.)	Ready-to-use	2.6	1.25g/cm ³	Fresh	3 years

INCOMPATIBLE MATERIALS: Do not mix with strong acids, bleach or any other cleaners.



fantastik® Multi-Surface Disinfectant Degreaser

WHERE TO USE:

For use in Businesses, Offices, Restaurants, Retail Stores, Hotels & Motels, Bed and Breakfast Inns, Homes, Convenience Stores, Automotive Shops, Buses, Cars, Cruise Ships and Airplanes. Cleans appliances, refrigerator exteriors, dishwasher exteriors.

- Removes 100% soap scum and grease
- Cleans, disinfects, degreases and deodorizes
- Leaves a pleasant scent
- Kills 99.9% of viruses* & bacteria* when used as directed on hard non-porous surfaces
- Multi-purpose daily cleaner

* Herpes Simplex Virus Type 1, Herpes Simplex Virus Type 2, Influenza A (H1N1) Virus, Respiratory Syncytial Virus, Rotavirus, Parainfluenza virus type 3, Human Coronavirus, SARS-CoV-2.
 *Staphylococcus aureus (Staph), Salmonella enterica (Salmonella), Pseudomonas aeruginosa, Enterobacter aerogenes, Escherichia coli O157:H7 (E. coli), Listeria monocytogenes, Methicillin Resistant Staphylococcus aureus (MRSA), Vancomycin Resistant Enterococcus faecalis (VRE), Streptococcus pyogenes, Enterococcus faecalis, Campylobacter jejuni. Use pesticides safely. Always read label and product information before use.

Hard Surface Care		
CODE	CASE QTY	SIZE
311836	8	32oz Spray Bottle
311930	4	128oz Refill



Windex® Multi-Surface Disinfectant Sanitizer Cleaner

WHERE TO USE:

For Use on: Aluminum, Chrome, Countertops & Sinks, Exterior Appliance Surfaces, Glazed Ceramic Tile, Sealed Granite & Marble, Stainless Steel.

- This product will clean and shine surfaces without any dull residue
- When used as directed, it kills 99.9% of viruses* and bacteria* on hard, non-porous surfaces
- Great for cleaning bathrooms, kitchens, tiles, stainless steel, and more.
- To sanitize* hard non-porous surfaces: Pre-clean visibly soiled areas. Spray surface until thoroughly wet. Allow surface to remain visibly wet for 10 seconds. Wipe

* Rhinovirus Type 37 (common cold), Influenza A2/Hong Kong (H3N2), Influenza B, SARS-CoV-2 (Strain USA-WA1/2020).
 *Staphylococcus aureus (Staph), Enterobacter aerogenes (Enterobacter), Escherichia coli (E. coli), Salmonella enterica (Salmonella), Campylobacter jejuni, Listeria monocytogenes (Listeria), Streptococcus pyogenes (Strep). Use pesticides safely. Always read label and product information before use.

Hard Surface Care		
CODE	CASE QTY	SIZE
322369	8	32oz Spray Bottle
682265	4	128oz Refill
682266	12	32oz Spray Bottle



Scrubbing Bubbles® Disinfectant Restroom Cleaner II

WHERE TO USE:

Countertops, shower walls & doors, sinks, tubs and vanity tops. Not recommended for use on acrylic fixtures. Spot test all other hard, non-porous surfaces in an inconspicuous area.

- When used as directed, this disinfectant product kills 99.9% of viruses* & bacteria* on hard non-porous surfaces**.
- This heavy-duty, multi-purpose cleaner removes 100% soap scum while leaving behind a brilliant shine.
- Foaming action easily removes lime scale, calcium, rust and dirt. Cleans, shines and freshens without harsh fumes.

* Herpes Simplex Virus Type 1, Herpes Simplex Virus Type 2, Influenza A (H1N1) Virus, Respiratory Syncytial Virus, Rotavirus, SARS-CoV-2.
 *Staphylococcus aureus (Staph), Salmonella enterica (Salmonella), Pseudomonas aeruginosa, Enterobacter aerogenes, Escherichia coli O157:H7 (E. coli), Listeria monocytogenes, Methicillin Resistant Staphylococcus aureus (MRSA). Use pesticides safely. Always read label and product information before use.
 **When used according to disinfection directions.

Hard Surface Care		
CODE	CASE QTY	SIZE
313358	12	25oz Aerosol Can



Quaternary Disinfectant Cleaner

WHERE TO USE:

Washable hard, non-porous, surfaces of appliances exteriors, bathroom fixtures, countertops, desks, doorknobs, floors, garbage cans, and bed frames. Sanitizes soft surfaces as a spot treatment in 5 minutes. Is a proven soft surface spot sanitizer against: Staphylococcus aureus, Enterobacter aerogenes. For use on soft surfaces such as upholstery, fabric, curtains, and bedding. This product kills SARS-CoV-2 virus, the cause of COVID-19, when used as directed.

- Effective one-step virucide disinfectant cleaner that, when used as directed, is effective against a broad spectrum of bacteria, is virucidal*, fungicidal, and inhibits the growth of mold and mildew.
- Tested according to AOAC Use-Dilution Method.

As a disinfectant, Quaternary Disinfectant Cleaner kills:

Bacteria: Pseudomonas aeruginosa (Pseudomonas), Staphylococcus aureus (Staph), Salmonella enterica (Salmonella), Acinetobacter baumannii, Burkholderia cepacia, Campylobacter jejuni, Corynebacterium ammoniagenes, Enterobacter aerogenes, Enterobacter cloacae NDM-1 positive, Enterococcus faecalis (Enterococcus), Enterococcus faecalis-Vancomycin Resistant (VRE), Escherichia coli (E. coli), Escherichia coli - New Delhi Metallo-Beta Lactamase (NDM-1), ESBL Escherichia coli - (Extended spectrum beta-lactamase producing E. coli), Klebsiella pneumoniae (Klebsiella), Klebsiella pneumoniae - NDM-1 positive, Legionella pneumophila, Listeria monocytogenes (Listeria), Salmonella schottmuelleri (Salmonella), Salmonella typhi (Salmonella), Serratia marcescens (Serratia), Shigella dysenteriae (Shigella), Staphylococcus aureus - Community Associated Methicillin-Resistant (CA-MRSA) (NRS384) (USA300), Staphylococcus aureus - Community Associated Methicillin-Resistant (CA-MRSA) (NRS123) (USA400), Staphylococcus aureus - Methicillin-Resistant (MRSA), Staphylococcus aureus - Multi-Drug Resistant (resistant to tetracycline (Tc), penicillin (Pc), streptomycin (Sm) and erythromycin (Em) and susceptible to chloramphenicol (Cm) in vitro), Staphylococcus aureus-Vancomycin Intermediate Resistant - (VISA), Streptococcus pyogenes (Strep), Vibrio cholerae
 Viruses: *SARS-Related Coronavirus 2 (cause of COVID-19), *Hepatitis B Virus (HBV), *Hepatitis C Virus (HCV), *Herpes Simplex Virus Type 1, *Herpes Simplex Virus Type 2, *HIV-1 (AIDS Virus), *Human Coronavirus, *Influenza Virus Type A / Brazil (Influenza), *Influenza Virus Type A / H3N2 (Influenza), *Influenza A Virus (H7N9), *Respiratory Syncytial Virus (RSV), *SARS Associated Coronavirus (SARS) (cause of Severe Acute Respiratory Syndrome), *Vaccinia Virus, Adenovirus Type 5, *Adenovirus

CODE	DESCRIPTION	QTY	SIZE	DILUTION RATIO	PH (RTU)	DENSITY	FRAGRANCE	SHELF LIFE
680066	Squeeze & Pour Bottle	6	1 Quart (32 fl. oz.)	1:32-1:256	13	1.005g/cm ³	Fragrance-Free	2 years

INCOMPATIBLE MATERIALS: Do not mix with strong acids, bleach or any other cleaners.



Click Here Also for restrooms try our line of Refresh™ FOAM Soaps



FABRIC & AIR CARE

FABRIC & AIR CARE

FRESHEN UP YOUR SPACES WITH SC JOHNSON PROFESSIONAL'S FABRIC AND AIR CARE PRODUCTS. AVAILABLE IN A VARIETY OF DIFFERENT SCENTS AND FORMATS TO ASSIST USERS IN PROVIDING CUSTOMERS WITH A PLEASANT EXPERIENCE AT THEIR FACILITY.



WHERE TO USE:
Any room where freshening is needed.

- Each is infused with essential oil extracts and comes in a variety of fragrances
- Use daily or as the final touch after cleaning
- Glade Room Spray fights odor, making your business uniquely inviting for all

Fabric & Air Care

CODE	CASE QTY	SIZE
682262 Super Fresh	12	13.8 Aerosol Can
682263 Hawaiian Breeze®	12	13.8 Aerosol Can
682277 Clean Linen®	12	13.8 Aerosol Can
697248 Lavender & Vanilla	12	13.8 Aerosol Can



WHERE TO USE:
Perfect for on the go use to treat fabric stains. Keep in purse, briefcase, backpack, in vehicles, restaurant stations.

- Made portable, so you can use them to remove on-the-go stains right away
- Larger count size great for use in commercial, industrial & institutional facilities.

Fabric & Air Care

CODE	CASE QTY	SIZE
686661	1	Wipes Box of 80

RTU Fabric & Air Odor Freshener



WHERE TO USE:
Any room where freshness is needed. Do not use on leather, suede or silk. Avoid overspray on hard surface flooring.

- Helps refresh the air and soft surfaces
- Specially formulated with our signature Fresh Scent, quickly freshen public spaces with a pleasant, balanced fragrance that complements the SC Johnson Professional® hard surface cleaners

CODE	DESCRIPTION	QTY	SIZE	DILUTION RATIO	PH (RTU)	DENSITY	FRAGRANCE	SHELF LIFE
680073	Ready to Use Trigger Sprayer	12	1 Quart (32 fl. oz.)	Ready-to-Use	5.5	1.00g/cm ³	Fresh	4 years

INCOMPATIBLE MATERIALS: Do not mix with strong acids, bleach or any other cleaners.

Mrs. **MEYER'S**
CLEAN DAY

Rooted in Goodness®



Garden-Inspired Scents • Cruelty-Free Formula • Made with Essential Oils & Other Thoughtfully Chosen Ingredients • Recyclable Packaging (less pumps & caps)



Smells like a **GARDEN.**



Click Here for more product information



SPECIALTY OFFERINGS

PEST • STORAGE • TECHNOLOGY SOLUTIONS

SC JOHNSON PROFESSIONAL'S SPECIALTY OFFERINGS INCLUDE TRUSTED BRANDS MADE AVAILABLE FOR PROFESSIONALS. IN ADDITION TO THESE PRODUCTS, THE FACILISCAN™ FACILITY AUDITING APPLICATION SUPPORTS USERS IN THEIR CUSTODIAL MAINTENANCE MANAGEMENT PROCESS BY EASING THE FACILITY AUDIT PROCESS.



Deep Woods® Insect Repellent

WHERE TO USE:
Personal Repellents. Read label before use. Use only as directed.

Pest Control		
CODE	CASE QTY	SIZE
611081	12	6oz Aerosol Can

- Formulated with 25% DEET—provides up to 8 hours of protection against biting insects such as ticks, mosquitoes, black flies, sand flies, chiggers, and gnats. It also repels fleas and no-see-ums



Wasp & Hornet Killer

WHERE TO USE:
Kills: Hornets, Mud daubers, Wasps, Yellow Jackets. Read label before use. Use only as directed.

Pest Control		
CODE	CASE QTY	SIZE
668006	12	14oz Aerosol Can

- Allows you to attack from a distance, killing the entire nest
- It kills wasps and hornets on contact and is electrically non-conducting up to 32,500 volts



Ant & Roach Killer Outdoor Fresh® Scent

WHERE TO USE:
Kills: Ants, Crickets, Multi-colored Asian Lady Beetles, Roaches, Silverfish, Household & Black Widow Spiders, Waterbugs. Read label before use. Use only as directed.

Pest Control		
CODE	CASE QTY	SIZE
351104	12	17.5oz Aerosol Can

- Kills on contact and keeps killing with residual action for up to four weeks
- This easy-to-use spray ensures complete coverage of the areas that ants, roaches and other listed bugs may be infesting



Ant & Roach Killer Fragrance Free

WHERE TO USE:
Kills: Ants, Crickets, Multi-colored Asian Lady Beetles, Roaches, Silverfish, Household & Black Widow Spiders, Waterbugs. Read label before use. Use only as directed.

Pest Control		
CODE	CASE QTY	SIZE
333822	12	17.5oz Aerosol Can

- Kills on contact and keeps killing with residual action for up to four weeks
- This easy-to-use spray ensures complete coverage of the areas that ants, roaches and other listed bugs may be infesting



Flying Insect Killer Outdoor Fresh® Scent

WHERE TO USE:
KILLS: Asian Lady Beetles, Boxelder Bugs, Flies, Fruit Flies, Hornets, Mosquitoes, Non-biting Gnats, Small Flying Moths, Wasps, Yellow Jackets. Read label before use. Use only as directed

Pest Control		
CODE	CASE QTY	SIZE
300816	12	15oz Aerosol Can

- Specially formulated to kill a number of flying insects including flies, mosquitoes, wasps, and hornets
- Can be used both indoors and outdoors.



MAX Perimeter Protection Trigger Starter

WHERE TO USE:
Raid MAX® Perimeter Protection kills a wide range of bugs and creates a consistent barrier thanks to its effective and reliable formula. For both indoor and outdoor use. Read label before use. Use only as directed

Pest Control		
CODE	CASE QTY	SIZE
316222	4	128oz Trigger
316224	6	Gallon Starter Kit
316225	4	Gallon Refill

- Kills a wide range of bugs and creates a consistent barrier thanks to its effective and reliable formula
- KILLS: Ants, Fleas, Flies, Gnats, Roaches, Ticks, Silverfish, Crickets, Spiders, Mosquitoes, Centipedes, Firebrats, Small Flying Moths, Stink Bugs, Sowbugs, Ground Beetles, Boxelder Bugs
- Keeps American cockroaches and Argentine ants away for up to 18 months on non-porous surfaces



Ziploc Brand Sandwich Bags

WHERE TO USE:
Storing and organizing food and other items.

- Featuring our Grip N Seal Technology
- Our triple system seal features an extended tab, easy grip texture and a double zipper
- The extended tab and easy grip seal make it easier to open and close the bag, while the airtight zipper ensures that each plastic sandwich bag blocks out air for less wasted food and more money saved
- Kosher Certified. Made to meet FDA requirements for food contact

Storage		
CODE	CASE QTY	SIZE
682255	1	Box of 500



Ziploc Brand Storage Bags

WHERE TO USE:
Storing and organizing food and other items.

- Protect food with Ziploc Brand Storage Bags
- Featuring Grip 'n Seal Technology
- Kosher Certified. Manufactured to meet FDA requirements for food contact.
- Quart and Gallon bags feature our triple system seal features an extended tab, easy grip texture and a double zipper
- Write-on label

Storage		
CODE	CASE QTY	SIZE
682256	1	Quart Box of 500
682257	1	Gallon Box of 250
682253	1	2 Gallon Box of 100



Ziploc Brand Freezer Bags

WHERE TO USE:
Storing and organizing food and other items.

- Protect food with Ziploc Brand Freezer Bags
- Each bag locks out freezer burn while keeping food fresh and full of taste.
- Available in 1 Gallon and 1 Quart sizes
- Kosher Certified. Manufactured to meet FDA requirements for food contact.
- Write-on label

Storage		
CODE	CASE QTY	SIZE
696187	1	Quart Box of 300
682258	1	Gallon Box of 250
682254	1	2 Gallon Box of 100



Click Here In the kitchen? Try our
AgroBac™ PURE

faciliscan™

SOFTWARE DESIGNED AND BUILT FOR CUSTODIAL MAINTENANCE MANAGEMENT

faciliscan™ is a mobile facility auditing application created to ease the facility cleaning and estimating process by simplifying quality assurance audits, managing performance, and helping you address corrective actions.

Web-based Admin Site for Desktop

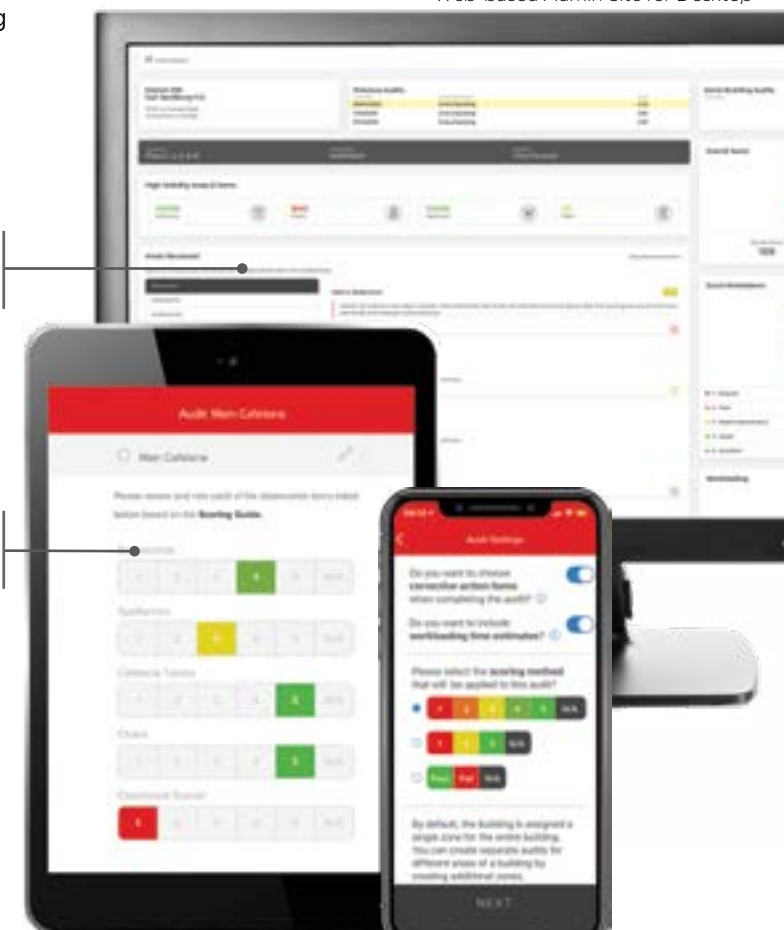

Auditing & Estimating tool
iOS & Android Compatible

EASY-TO-USE ADMIN SITE

PROVIDES FLEXIBILITY, INSIGHTS, AND CUSTOMIZATION TO MEET EVERY NEED

ROBUST AUDIT TOOL

CUSTOMIZE AND MANAGE DETAILS OF FACILITY AUDITS



USERS

Securely manage user access and permissions

DEVICES

Monitor number of active devices

ACCOUNTS

Create database of building accounts and contacts

AUDITS & ESTIMATES

See a snapshot of audits and estimates performed

ALONG WITH ALL OF OUR OTHER GREAT SC JOHNSON PROFESSIONAL® PRODUCTS, YOU ALSO HAVE ACCESS TO **OVER 1500** EASY-TO-CHOOSE PRODUCTS USED IN ALL APPLICATIONS, MARKETS & INDUSTRIES.

CLEANING



PEST CONTROL



STORAGE



LIFESTYLE BRANDS



SPECIALTY



AIR CARE



scJohnson
PROFESSIONAL
A family company®

www.scjp.com

